

Adjustable Handle

DOUBLE SOCKET RATCHET WRENCHES



Adjustable head helps get to those hard-to-reach nuts and bolts!

- Heavy-duty double socket incorporates a through design which can tighten nuts on long bolts or all-thread rod without bottoming out.
- Double socket permits use on either 5/8" or 3/4" Heavy Hex Nuts without changing sockets. Also eliminates common misplacement of loose sockets and introduction of dirt into the mechanism while changing sockets in the field.
- Increased number of socket teeth requires less stroke to ratchet.
- Improved heavy-duty ratchet mechanism is lubricated and enclosed in a sealed ductile iron casting to prevent debris from jamming. Now includes an oiler that allows lubrication without disassembly!
- Wrench is painted black and is 16" O.A.L.

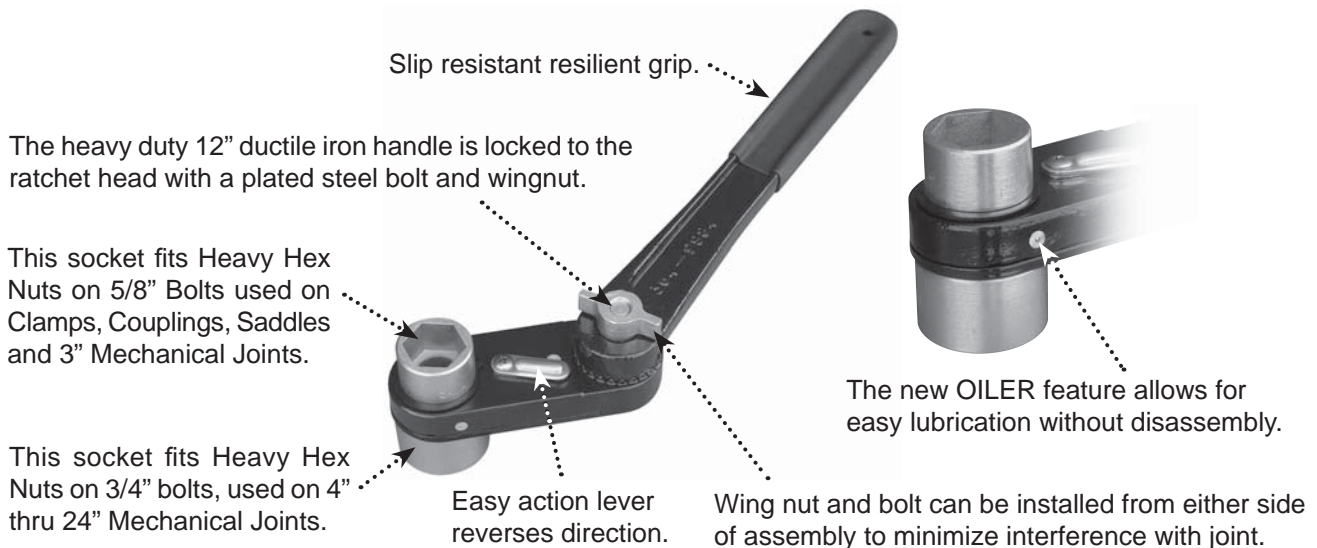

Trumbull Item No.	Large Socket	Small Socket	Large Socket Fits Hex Size	Small Socket Fits Hex Size	Examples of Large Socket Applications	Examples of Small Socket Applications	Product Weight
364-9984	1-1/4"	1-1/16"	3/4" Heavy	5/8" Heavy	4" thru 24" MJ Ftgs., 3/4" Hex Bolts with Heavy Hex	3" MJ Ftgs., Cast Couplings,	4.50 lbs.
364-9955	36mm	30mm	M24	M20	400mm - 500mm Pipe Flanges	200mm - 350mm Pipe Flanges	2.05 KG