

TRUMBULL INDUSTRIES, INC.

1040 N. Meridian Rd., P.O. Box 1556, Youngstown, Ohio 44501 Phone: (330) 799-3333
www.trumbull-mfg.com Toll Free: 1-800-677-1799 FAX: (330) 797-3215

ADJUSTABLE STEM GUIDES FOR LARGE DIAMETER STEMS

Trumbull Stem Guides are designed as wall brackets for installation in treatment plants and pump stations to provide support for valve extension stems.

This ductile iron Stem Guide accommodates larger stem diameters, expanding the bore capacity of our Adjustable Stem Guide product line. Furnished with a split bronze bushing to fit stem sizes from 2" to 4" outside diameters. The adjustment range will allow stem centerlines as close to the wall as 2-3/4", or as far as 17-1/4".

Trumbull Item No.	Adjustment	Weight
367-6960	2-3/4" - 17-1/4"	40#

Stem guides are generally recommended at 10 feet intervals.

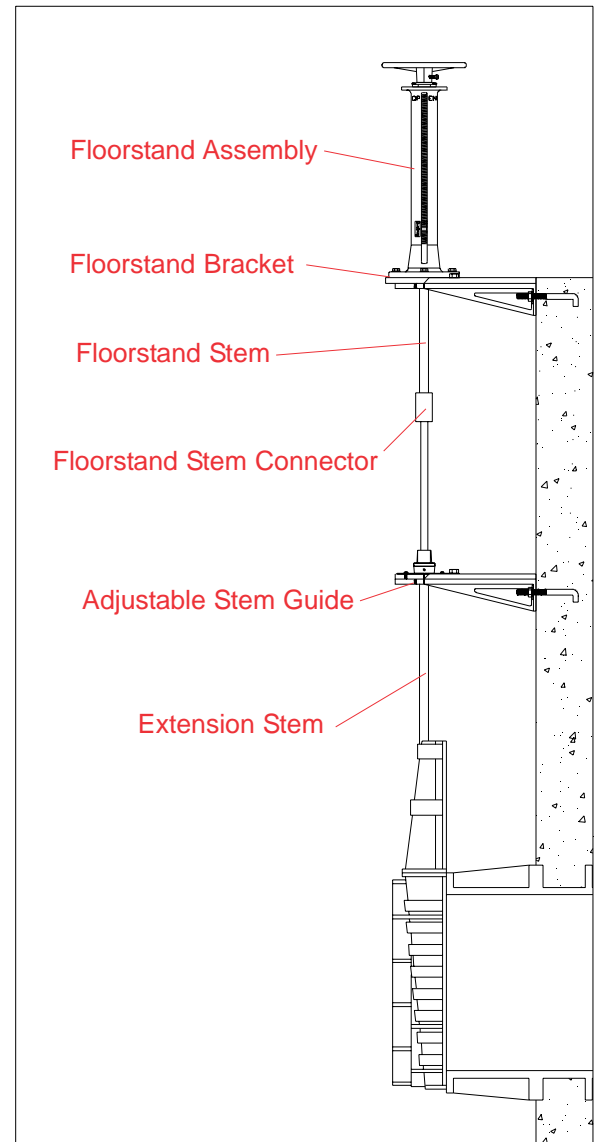
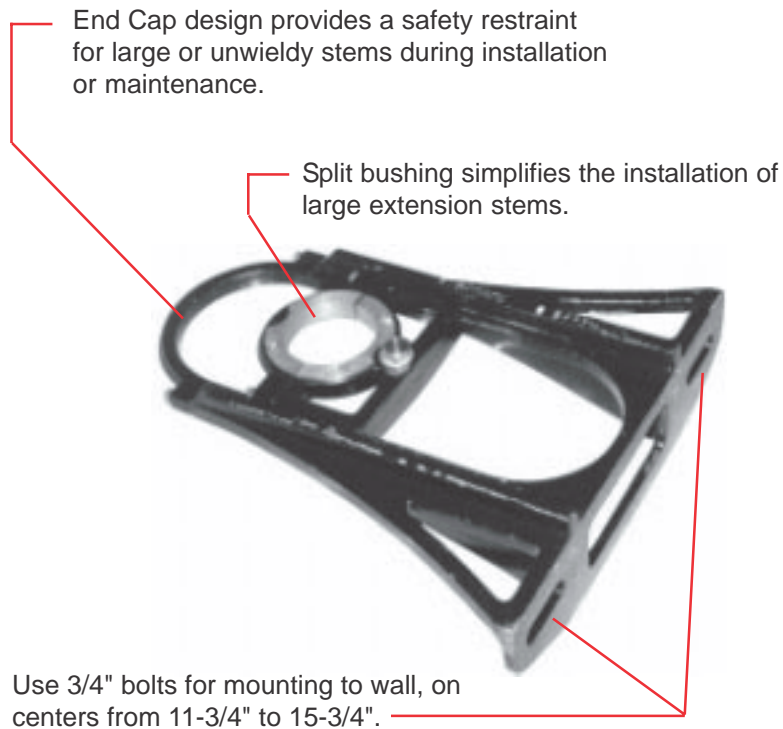

Typical Stem Guide installation.

Ordering Information:

1. Quantity.
2. Trumbull item number (#367-6960).
3. O.D. of stem being used, or desired bushing hole size (2-1/8" bore dia. supplied if not specified.)

See separate literature on Trumbull Floor Boxes, Extension Stems, Mud Valves, Stem Guides for smaller stem diameters and Chainwheels.

Stem Guides are also available in Stainless Steel; please inquire.

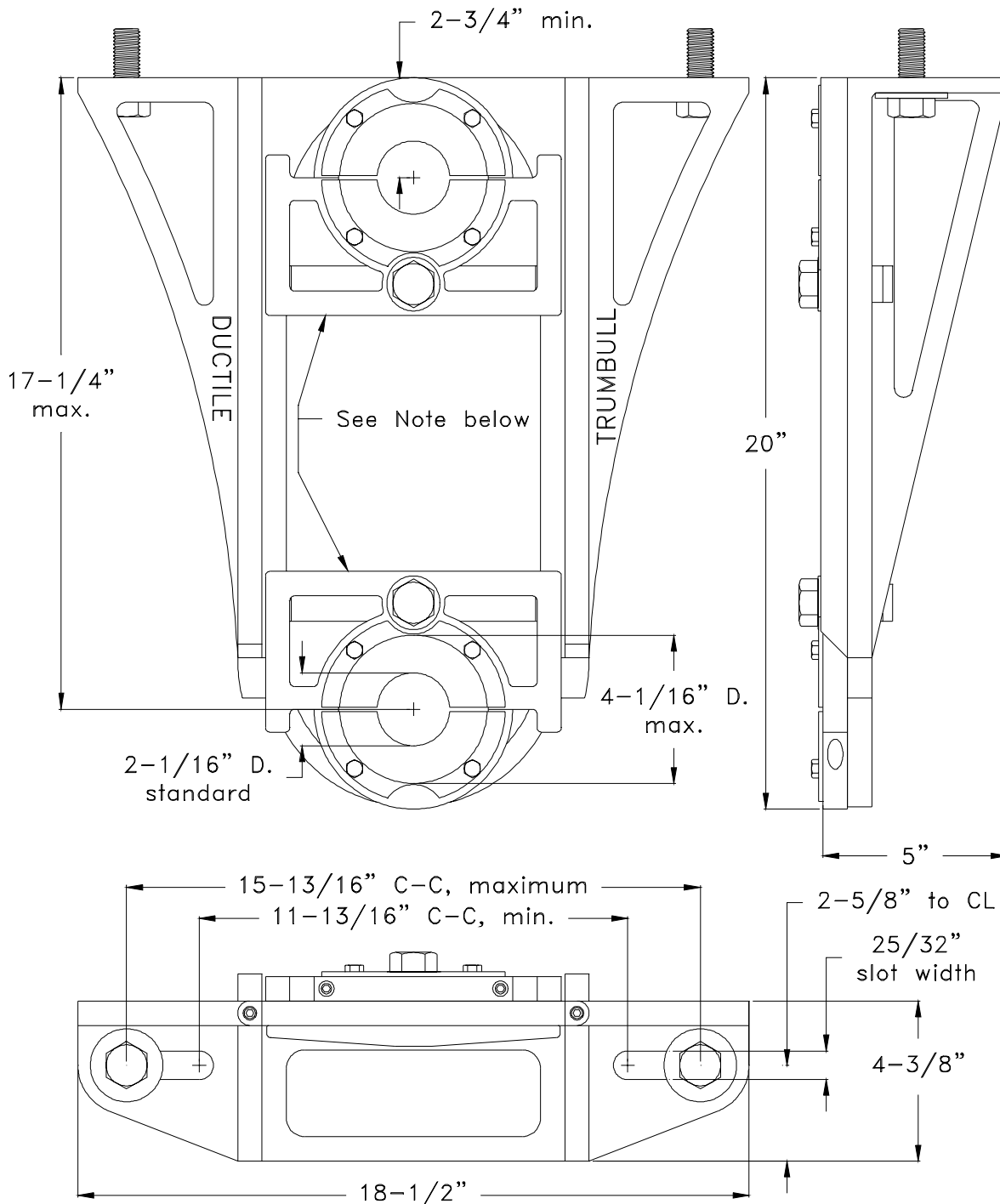

Note: Guide Arm shown in both fully back and fully forward positions; only one Guide Arm is supplied.
 Mounting Bolts are not supplied.

Material:

- Castings - Ductile Iron (65-45-12)
- Bushing - UNS C86400 Bronze
- Fasteners - Stainless Steel

Weight: 43# total

Drawn: Drawing Revision: Date Rev. Date 8/23/99 E 12/11/01		TRUMBULL INDUSTRIES P.O. Box 1556 1040 N. Meridian Rd. Youngstown, Ohio 44501	Drawn to Scale LARGE BORE STEM GUIDE
--	--	---	--