

Meter Wrench

Trumbull's Meter Wrench is used to install and remove meter couplings in buried meter boxes and meter pits. The 16" handle allows worker easy access into these confined areas.

Works with 1/2" through 1-1/2" meter couplings. Special features include resilient grip on handle and replaceable jaws.

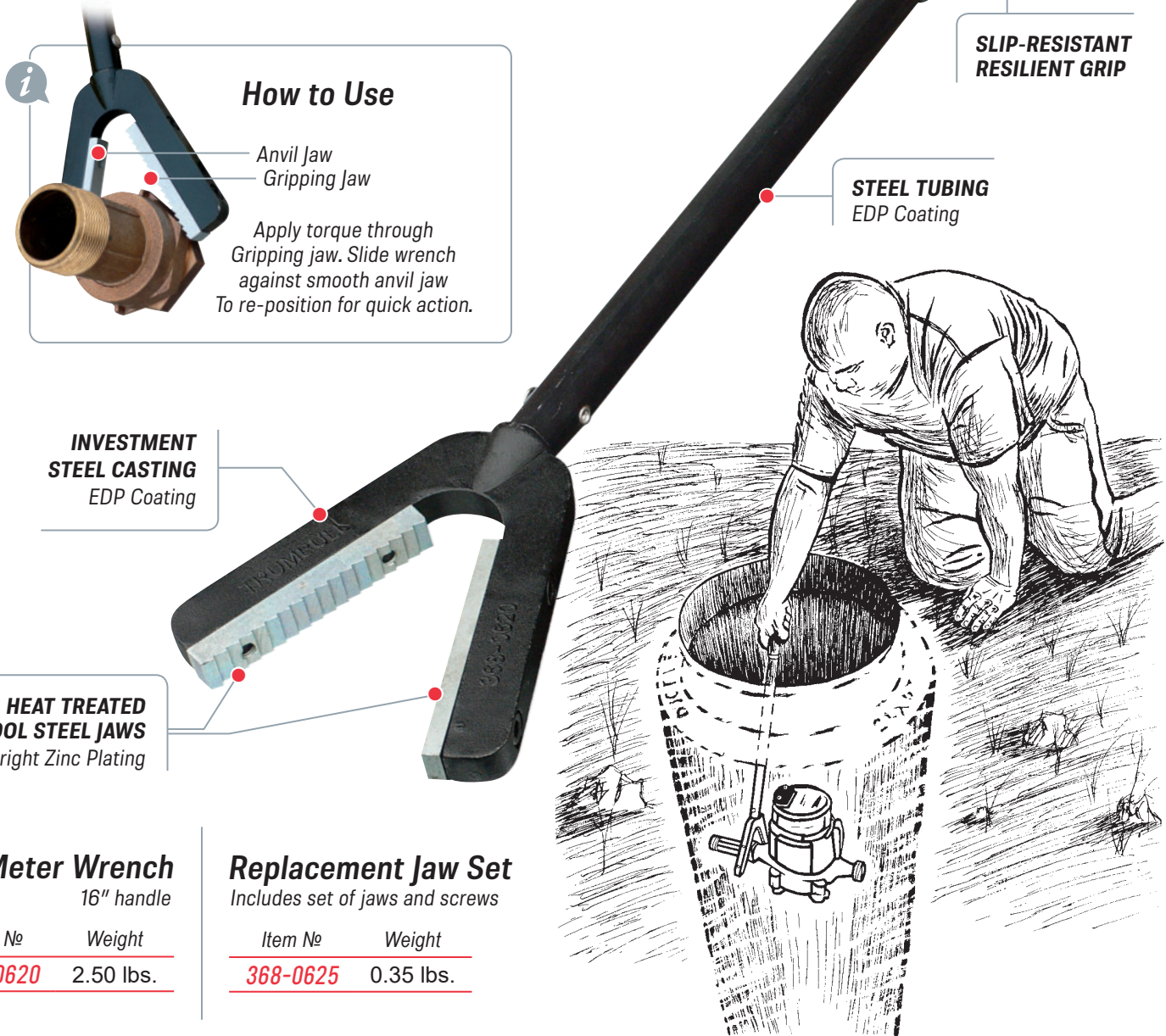

**SLIP-RESISTANT
RESILIENT GRIP**

**STEEL TUBING
EDP Coating**



How to Use

Anvil Jaw
Gripping Jaw

Apply torque through Gripping jaw. Slide wrench against smooth anvil jaw To re-position for quick action.

**INVESTMENT
STEEL CASTING
EDP Coating**

**HEAT TREATED
TOOL STEEL JAWS
Bright Zinc Plating**

Meter Wrench 16" handle

Item No	Weight
368-0620	2.50 lbs.

Replacement Jaw Set Includes set of jaws and screws

Item No	Weight
368-0625	0.35 lbs.